

SC60-COSMO

Fire and smoke damper cartridge



CE
0749



Table of content

Declaration of performance	3
Product presentation SC60-COSMO	4
Range and dimensions SC60-COSMO	4
Storage and handling	5
Installation	5
Placement specific to COSMO	6
Operation: manual opening	7
Operation: manual closing	8
Installation in rigid wall, sealing with gypsum plaster or mortar	9
Installation in rigid wall - insulated duct with mortar / gypsum sealing	10
Installation in rigid wall with stone wool $\geq 40 \text{ kg/m}^3$ and graphite sealant sealing	11
Installation in rigid wall - insulated duct with stone wool $\geq 40 \text{ kg/m}^3$ and graphite sealant sealing	12
Installation in rigid wall with fire batt and coating $\geq 140 \text{ kg/m}^3$ sealing	13
Installation in rigid wall - insulated duct with fire batt and coating $\geq 140 \text{ kg/m}^3$ sealing	14
Installation in asymmetric rigid wall with stone wool $\geq 40 \text{ kg/m}^3$ and graphite sealant sealing	15
Installation in asymmetric rigid wall - insulated duct with stone wool $\geq 40 \text{ kg/m}^3$ and graphite sealant sealing	16
Installation in flexible wall with stone wool $\geq 40 \text{ kg/m}^3$ and graphite sealant sealing	17
Installation in flexible wall - insulated duct with stone wool $\geq 40 \text{ kg/m}^3$ and graphite sealant sealing	18
Installation in flexible wall with gypsum sealing	19
Installation in flexible wall - insulated duct with gypsum sealing	20
Installation in flexible wall with fire batt and coating $\geq 140 \text{ kg/m}^3$ sealing	21
Installation in flexible wall - insulated duct with fire batt and coating $\geq 140 \text{ kg/m}^3$ sealing	22
Installation in asymmetric flexible wall with fire batt and coating $\geq 140 \text{ kg/m}^3$	23
Installation in asymmetric flexible wall - insulated duct with fire batt and coating $\geq 140 \text{ kg/m}^3$	24
Weights	25
Selection data	25
Sample order	25
Approvals and certificates	25

Explanation of the abbreviations and pictograms

Dn = nominal diameter	o -> i = meets the criteria from the outside (o) to the inside (i)	OP = option (delivered with the product)
E = integrity	GKB (type A) / GKF (type F): "GKB"	KIT = kit (delivered separately for repair or upgrade)
I = thermal insulation	stands for standard plasterboards (type A according to EN 520) while "GKF"	DAS MOD = modular product
S = smoke leakage: max. $200 \text{ m}^3/(\text{h m}^2)$ according to EN 1366-2	plasterboards offer a higher fire resistance for a similar plate thickness (type F according to EN 520)	dB(A) = A-weighted decibel value
Pa = pascal	Sn = free air passage	Lw oct = sound power level per octave midband
ve = vertical wall penetration	ζ [-] = pressure loss coefficient	ΔL = correction factor
ho = horizontal floor penetration	Q = airflow	
i <-> o = fire side not important	ΔP = static pressure drop	
	v = air speed in the duct	
	Lwa = A-weighted sound power level	



sealing with fire resistant stone wool boards allowed, also for asymmetric opening

DECLARATION OF PERFORMANCE

CE_DoP_Rf-t_S7_EN - E-01/01/2024

1. Unique identification code of the product-type:	SC60-COSMO
2. Intended use/s:	Circular fire and smoke damper for use at the height of a partition structure to maintain fire and smoke compartmentation in heating, ventilating and air conditioning installations (HVAC).
3. Manufacturer:	Rf-Technologies NV, Lange Ambachtstraat 40, B-9860 Oosterzele
4. System/s of AVCP:	System 1
5. Harmonised standard / European Assessment Document; notified body / European Technical Assessment, Technical Assessment Body, notified body; certificate of constancy of performance:	EN 15650:2010, BCCA with identification number 0749; BCCA-0749-CPR-BCT-606-0464-15650:09-25170
6. Declared performance according to EN 15650:2010	(Fire resistance according to EN 1366-2 and classifications according to EN 13501-3)

Range	Type	Wall	Sealing	Installation	Performance	
					Classification	Harmonised standard
SC60-COSMO Ø 100-200 mm	Rigid wall	Aerated concrete ≥ 100 mm	Mortar	1	EI 60 (V _{e,i} ↔ o) S - (300Pa)	EN 15650:2010
			Insulated duct (ArmaFlex EVO, ArmaFlex Ultima, ArmaFlex Protect – up to 13 mm) + mortar	1	EI 60 (V _{e,i} ↔ o) S - (300Pa)	
			Gypsum	1	EI 60 (V _{e,i} ↔ o) S - (300Pa)	
			Insulated duct (ArmaFlex EVO, ArmaFlex Ultima, ArmaFlex Protect – up to 13 mm) + gypsum	1	EI 60 (V _{e,i} ↔ o) S - (300Pa)	
			Stone wool ≥ 40 kg/m ³ + graphite kit	1	EI 60 (V _{e,i} ↔ o) S - (300Pa)	
			Insulated duct (ArmaFlex EVO, ArmaFlex Ultima, ArmaFlex Protect – up to 13 mm) + stone wool	1	EI 60 (V _{e,i} ↔ o) S - (300Pa)	
			Stone wool + coating ≥ 140 kg/m ³	1	EI 60 (V _{e,i} ↔ o) S - (300Pa)	
			Insulated duct (ArmaFlex EVO, ArmaFlex Ultima, ArmaFlex Protect – up to 13 mm) + stone wool	1	EI 60 (V _{e,i} ↔ o) S - (300Pa)	
			Stone wool + coating ≥ 140 kg/m ³	1	EI 60 (V _{e,i} ↔ o) S - (300Pa)	
			Insulated duct (ArmaFlex EVO, ArmaFlex Ultima, ArmaFlex Protect – up to 13 mm) + stone wool	1	EI 60 (V _{e,i} ↔ o) S - (300Pa)	
Flexible wall	Metal studs: gypsum plasterboard Type A (EN 520) ≥ 100 mm	Stone wool ≥ 40 kg/m ³ + graphite kit	1	EI 60 (V _{e,i} ↔ o) S - (300Pa)		
		Insulated duct (ArmaFlex EVO, ArmaFlex Ultima, ArmaFlex Protect – up to 13 mm) + stone wool	1	EI 60 (V _{e,i} ↔ o) S - (300Pa)		
		Stone wool + coating ≥ 140 kg/m ³	1	EI 60 (V _{e,i} ↔ o) S - (300Pa)		
		Insulated duct (ArmaFlex EVO, ArmaFlex Ultima, ArmaFlex Protect – up to 13 mm) + gypsum	1	EI 60 (V _{e,i} ↔ o) S - (300Pa)		
Massive shaftwall	Aerated concrete ≥ 100 mm	Stone wool + coating ≥ 140 kg/m ³	1	EI 60 (V _{e,i} ↔ o) S - (300Pa)		
		Insulated duct (ArmaFlex EVO, ArmaFlex Ultima, ArmaFlex Protect – up to 13 mm) + stone wool	1	EI 60 (V _{e,i} ↔ o) S - (300Pa)		
		Stone wool + coating ≥ 140 kg/m ³	1	EI 60 (V _{e,i} ↔ o) S - (300Pa)		
		Insulated duct (ArmaFlex EVO, ArmaFlex Ultima, ArmaFlex Protect – up to 13 mm) + stone wool	1	EI 60 (V _{e,i} ↔ o) S - (300Pa)		
Asymmetric flexible wall	Metal studs: gypsum plasterboard Type F (EN 520) ≥ 80 mm	Stone wool ≥ 40 kg/m ³ + graphite kit (sealing applied from one side)	1	EI 60 (V _{e,i} ↔ o) S - (300Pa)		
		Insulated duct (ArmaFlex EVO, ArmaFlex Ultima, ArmaFlex Protect – up to 13 mm) + stone wool	1	EI 60 (V _{e,i} ↔ o) S - (300Pa)		
		Stone wool + coating ≥ 140 kg/m ³ + graphite kit (sealing applied from one side)	1	EI 60 (V _{e,i} ↔ o) S - (300Pa)		
		Insulated duct (ArmaFlex EVO, ArmaFlex Ultima, ArmaFlex Protect – up to 13 mm) + stone wool	1	EI 60 (V _{e,i} ↔ o) S - (300Pa)		
1	Type of installation: built-in inside a duct, 0°					

Nominal activation conditions/sensitivity:	Pass
Response delay (response time): closure time	Pass
Operational reliability: cycling	50 cycles
Durability of response delay:	Pass
Durability of operational reliability:	Pass
Protection against corrosion according to EN 6068-2-52:	NPD (no performance determined)
Damper casing leakage according to EN 1751:	NPD (no performance determined)

The performance of the product identified above is in conformity with the set of declared performance/s. This declaration of performance is issued, in accordance with Regulation (EU) No 305/2011, under the sole responsibility of the manufacturer identified above.

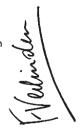
Signed for and on behalf of the manufacturer by:
Frank Verlinden, Head of Product Management

 Oosterzele, 01/01/2024



Product presentation SC60-COSMO

The fire and smoke damper cartridge SC60-COSMO provides a 60' fire resistance and protection against (cold) smoke spreading through the ventilation ducts. The damper is installed at the level of the fire separation and offers a fire resistance of up to 60 minutes. The SC60-COSMO also meets the WRD requirements Sa and S200 as stipulated in NEN 6075:2020. SC60-COSMO must be installed in supply and return air ducts. As the SC60-COSMO has been tested according to the test standard for fire dampers with a negative pressure of 300Pa, the ventilation system does not have to be switched off in case of fire and the mechanical supply and extraction may remain on. The SC60-COSMO may be used in residential buildings, where the damper is placed at the separation between the central supply and exhaust shaft and each residential unit. The damper is certified for installation in rigid and flexible walls, as well as in rigid shaftwalls or asymmetric plasterboard walls. The SC60-COSMO is also certified for use in (thermally and acoustically) insulated ventilation ducts.

- ☑ 1 certified solution that meets WBDBO and WRD requirements for both supply and extract air
- ☑ easy to install
- ☑ no space is lost at the wall crossing
- ☑ also suitable for insulated air ducts

- tested according to EN 1366-2 up to 300 Pa
- Complies with the provisions for fire dampers according to NEN 6075:2020, with classification Sa and S200
- suitable for installation in rigid wall, flexible wall (metal stud gypsum plasterboard wall), asymmetric rigid and flexible wall
- sealing with fire resistant stone wool boards allowed, also for asymmetric opening
- for indoor use
- ambient temperature below 50°C



1. steel tunnel
2. backdraft damper
3. rubber sealing ring
4. blades
5. fusible link
6. label indicating airflow direction and orientation
7. product identification

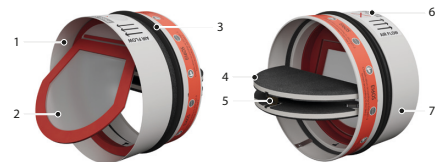

Range and dimensions SC60-COSMO

ØDn [mm]	100	125	160	200
----------	-----	-----	-----	-----

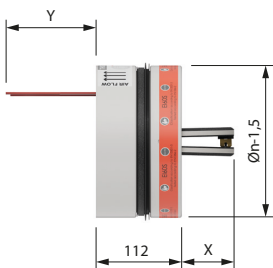

ØDn [mm]	100	125	160	200
X	18	31	49	69
Y	35	55	85	115

Storage and handling

As this product is a safety element, it should be stored and handled with care.

Avoid:

- any kind of impact or damage
- contact with water
- deformation of the casing

Installation

General points

- Verify if the blade can move freely.
- The fire damper cartridge must remain accessible for inspection and maintenance.
- Please observe safety distances with respect to other construction elements.

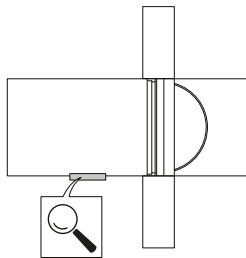

Product specific

- The installation must comply with the installation manual and the classification report.
- The results obtained in standardised supporting structures according to EN 1366-2 also apply to similar supporting structures with a fire resistance, thickness and density equal to or greater than the supporting structure of the test. More information on standardised supporting structures: <https://www.rft.eu/en-eu/page/fire-safety/legal-context/european-regulations/standardised-constructions>

Placement specific to COSMO

1

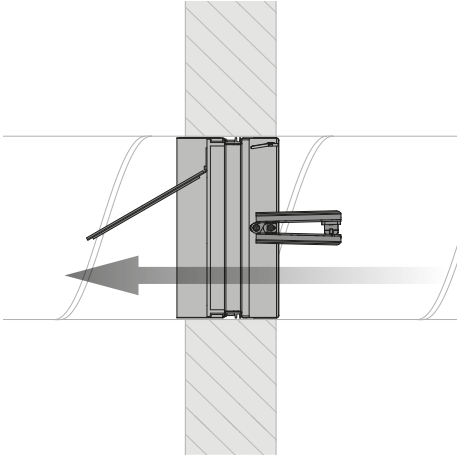

1. Installation direction for supply

2

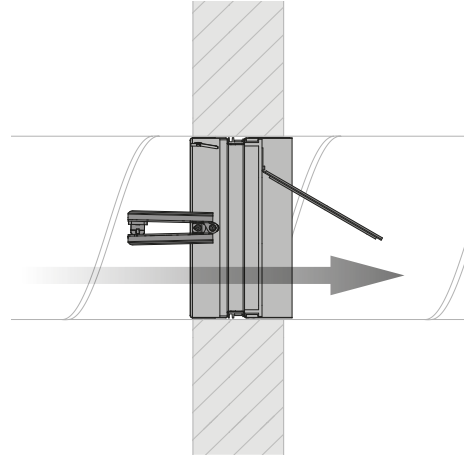

2. Installation direction for extraction

3

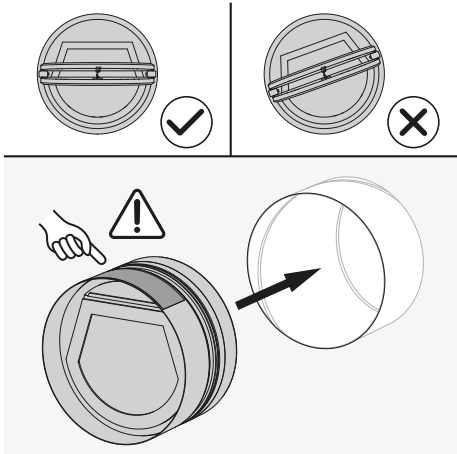

3. Orientation of the product

4

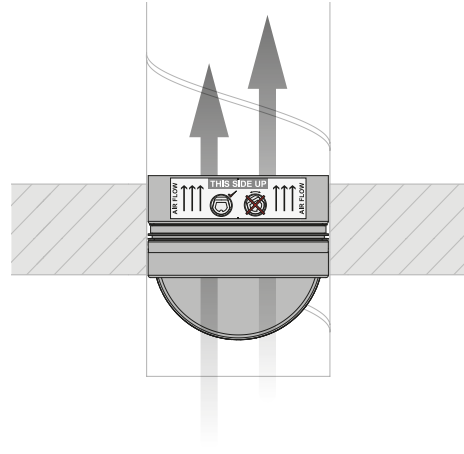

4. Top view

5

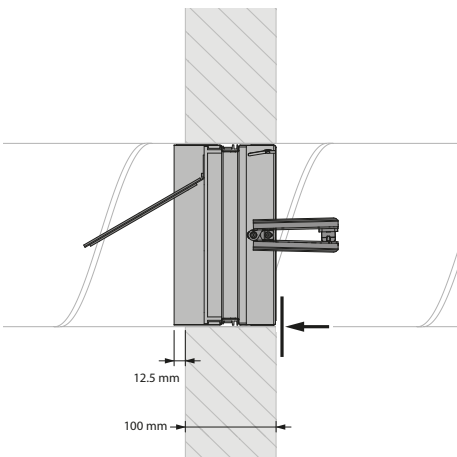

5. Placement in relation to compartment wall

6

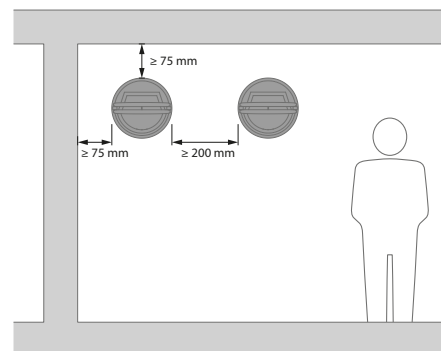

Operation: manual opening

1

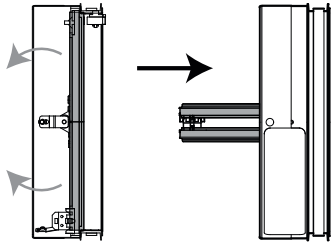

2

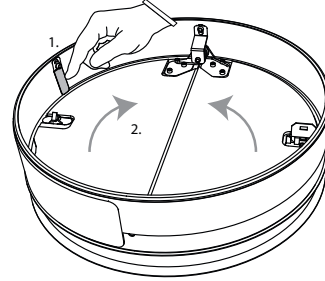

2. Press the two blocking hooks carefully to unlock the blades.

3

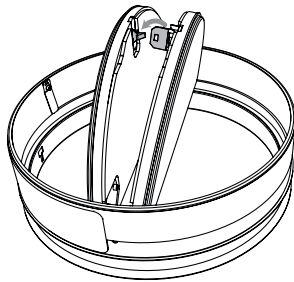

3. Click the fusible link into the holder to lock the blades.

Operation: manual closing

1

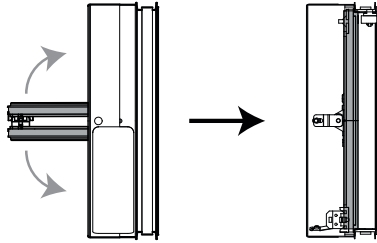

2

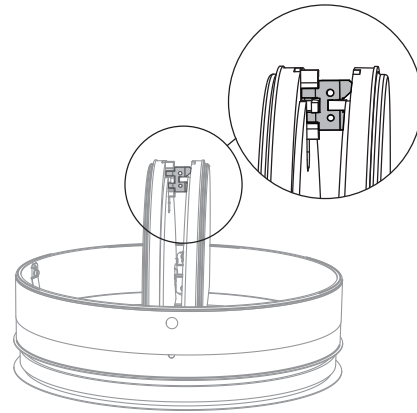

2. Unlock (close) the damper blades by pushing them towards each other. Carefully unlock the fusible link by pushing it sideways.

3

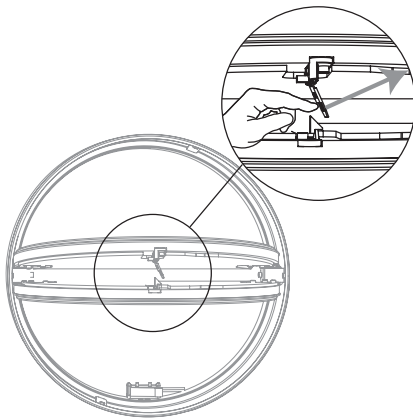

Installation in rigid wall, sealing with gypsum plaster or mortar

The product was tested and approved in:

Range	Wall type		Sealing	Classification
SC60-COSMO Ø 100-200 mm	Rigid wall	Aerated concrete ≥ 100 mm	Mortar	EI 60 (v _e i ↔ o) S - (300Pa)
SC60-COSMO Ø 100-200 mm	Rigid wall	Aerated concrete ≥ 100 mm	Gypsum	EI 60 (v _e i ↔ o) S - (300Pa)

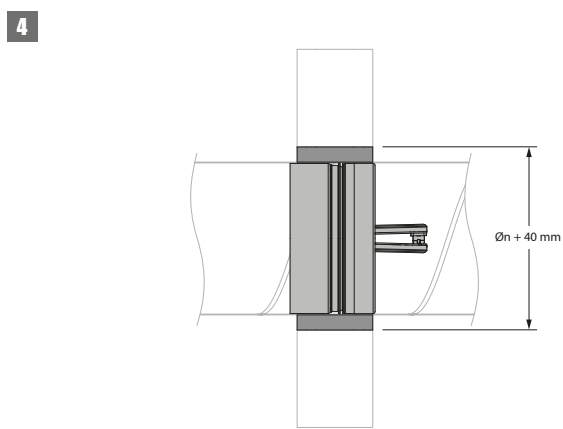
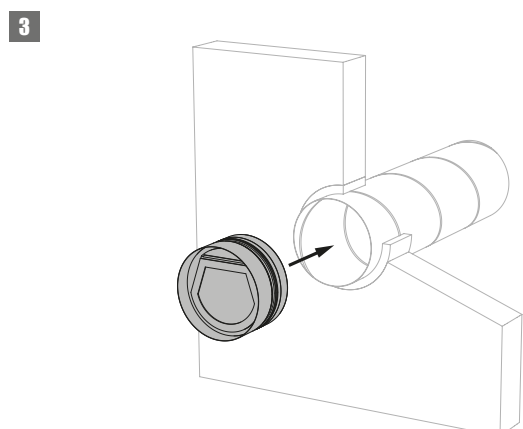
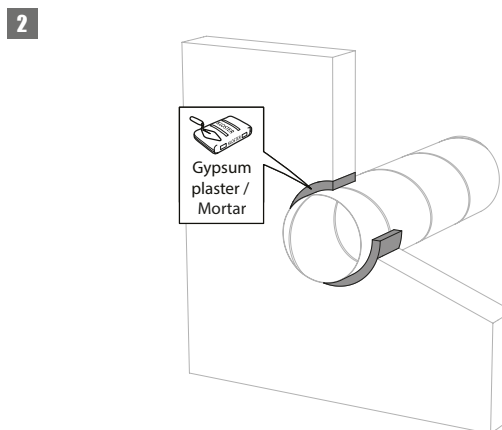
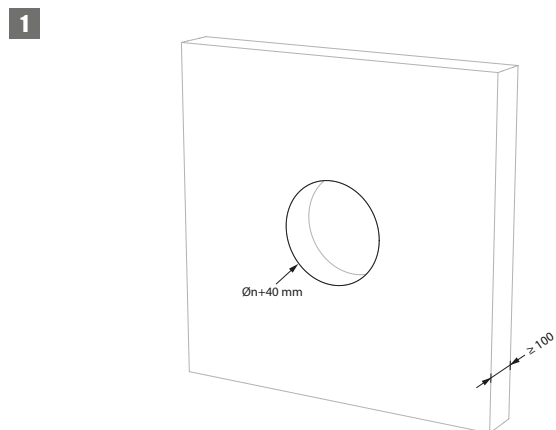

3. Place the SC60-COSMO in the correct direction and orientation.

Installation in rigid wall - insulated duct with mortar / gypsum sealing

The product was tested and approved in:

Range	Wall type	Sealing	Classification
SC60-COSMO Ø 100-200 mm	Rigid wall	Aerated concrete ≥ 100 mm	Insulated duct (ArmaFlex EVO, ArmaFlex Ultima, ArmaFlex Protect – up to 13 mm) + mortar
SC60-COSMO Ø 100-200 mm	Rigid wall	Aerated concrete ≥ 100 mm	Insulated duct (ArmaFlex EVO, ArmaFlex Ultima, ArmaFlex Protect – up to 13 mm) + gypsum

1

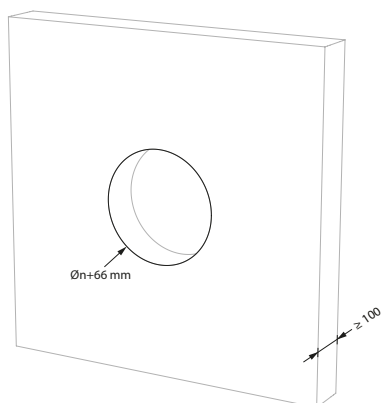

2

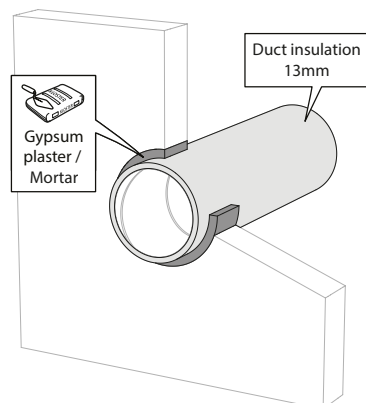

3

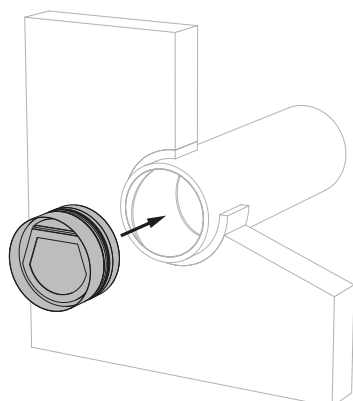

4

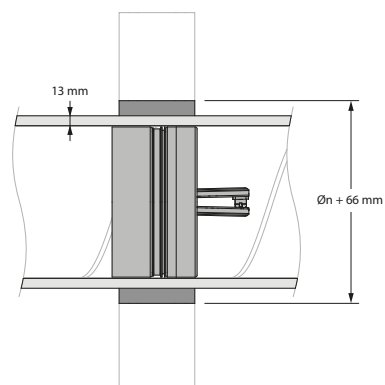

3. Place the SC60-COSMO in the correct direction and orientation.

Installation in rigid wall with stone wool $\geq 40 \text{ kg/m}^3$ and graphite sealant sealing

The product was tested and approved in:

Range	Wall type	Sealing	Classification
SC60-COSMO \varnothing 100-200 mm	Rigid wall	Aerated concrete $\geq 100 \text{ mm}$	Stone wool $\geq 40 \text{ kg/m}^3$ + graphite kit
			El 60 (v_e i \leftrightarrow o) S - (300Pa)

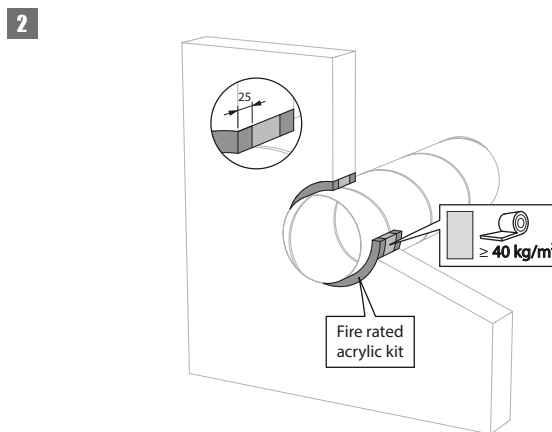
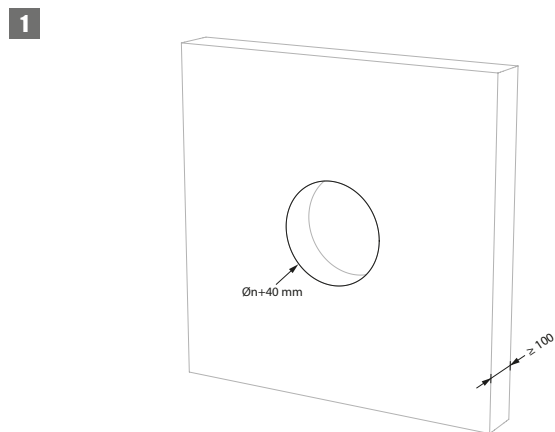

2. The opening around the duct is sealed with soft stone wool and filled with 25mm graphite sealant on both sides of the wall.

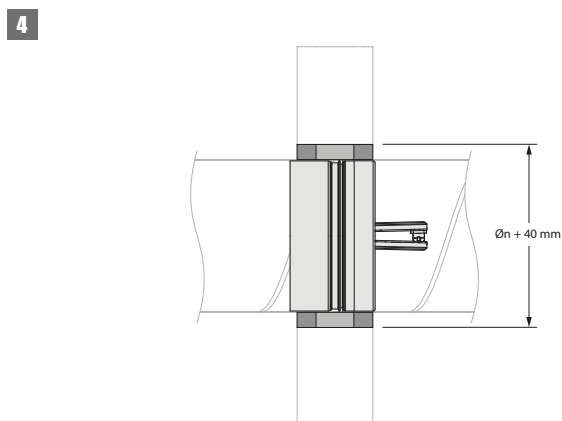
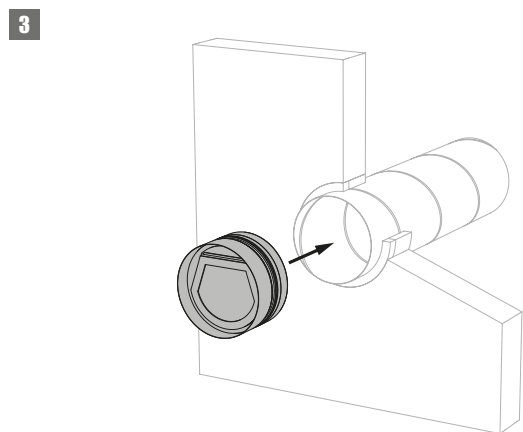

3. Place the SC60-COSMO in the correct direction and orientation.

Installation in rigid wall - insulated duct with stone wool $\geq 40 \text{ kg/m}^3$ and graphite sealant sealing

The product was tested and approved in:

Range	Wall type	Sealing	Classification
SC60-COSMO \varnothing 100-200 mm	Rigid wall	Insulated duct (ArmaFlex EVO, ArmaFlex Ultima, ArmaFlex Protect – up to 13 mm) + stone wool $\geq 40 \text{ kg/m}^3$ + graphite kit	El 60 (v_e i \leftrightarrow o) S - (300Pa)

1

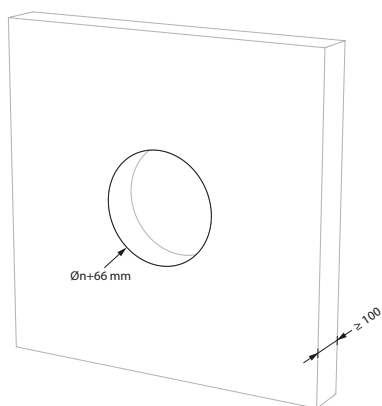

2

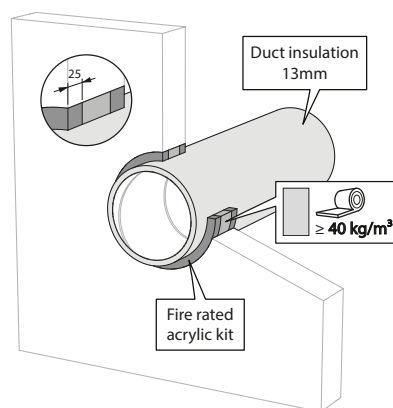

2. The opening around the duct is sealed with soft stone wool and filled with 25mm graphite sealant on both sides of the wall.

3

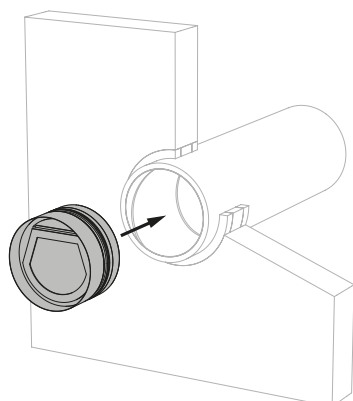

4

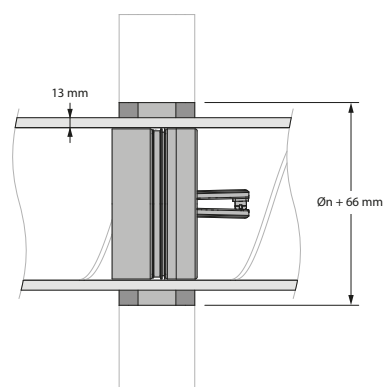

3. Place the SC60-COSMO in the correct direction and orientation.

Installation in rigid wall with fire batt and coating $\geq 140 \text{ kg/m}^3$ sealing

The product was tested and approved in:

Range	Wall type	Sealing	Classification
SC60-COSMO \varnothing 100-200 mm	Rigid wall	Aerated concrete $\geq 100 \text{ mm}$	Stone wool + coating $\geq 140 \text{ kg/m}^3$
			El 60 (v_e i \leftrightarrow o) S - (300Pa)

1

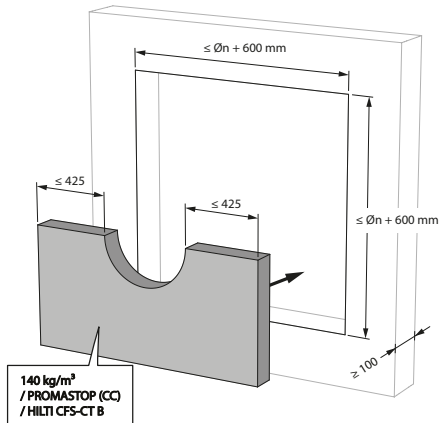

2

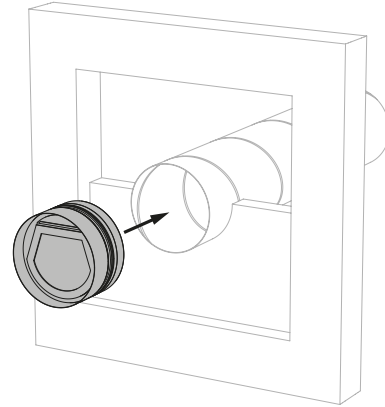

2. Place the SC60-COSMO in the correct direction and orientation.

3

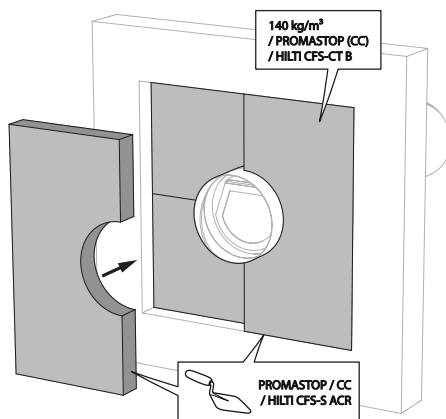

3. The opening in the wall around the duct is sealed with 2 layers of 50 mm-thick stone wool panels with fire resistant coating on one side (type PROMASTOP-CC 50 / HILTI CFS-CT B).

4

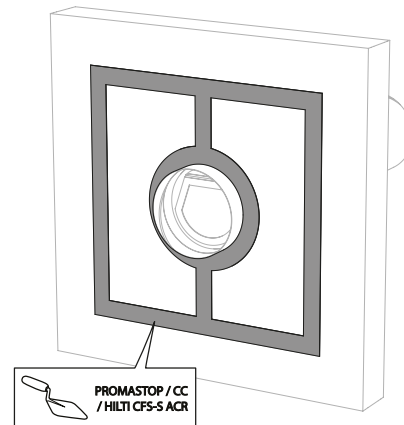

4. The joints on these 2 layers must be installed staggered and covered all around the edge with coating (type PROMASTOP-CC / HILTI CFS-S-ACR).

5

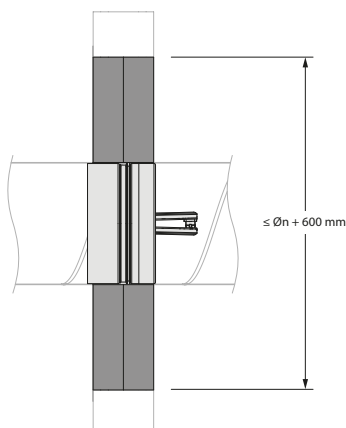

Installation in rigid wall – insulated duct with fire batt and coating $\geq 140 \text{ kg/m}^3$ sealing

The product was tested and approved in:

Range	Wall type	Sealing	Classification
SC60-COSMO \varnothing 100-200 mm	Rigid wall	Aerated concrete $\geq 100 \text{ mm}$ Insulated duct (ArmaFlex EVO, ArmaFlex Ultima, ArmaFlex Protect – up to 13 mm) + stone wool + coating $\geq 140 \text{ kg/m}^3$	El 60 (v_e i \leftrightarrow o) S - (300Pa)

1

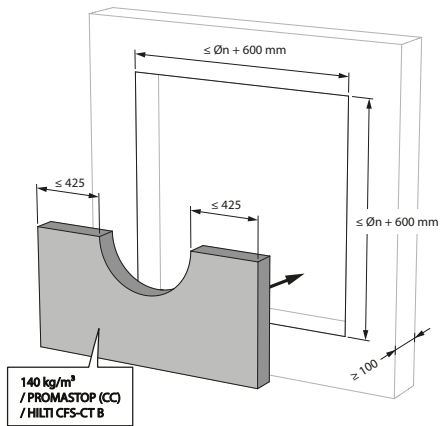

2

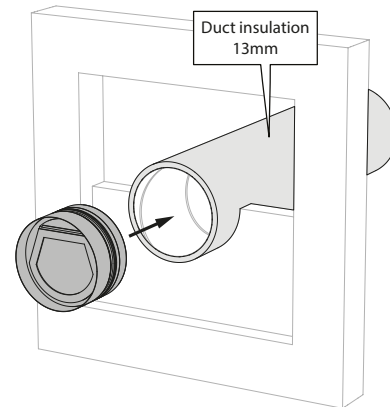

2. Place the SC60-COSMO in the correct direction and orientation.

3

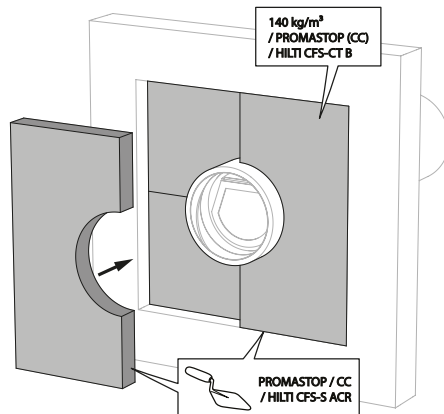

3. The opening in the wall around the duct is sealed with 2 layers of 50 mm-thick stone wool panels with fire resistant coating on one side (type PROMASTOP-CC 50 / HILTI CFS-CT B).

4

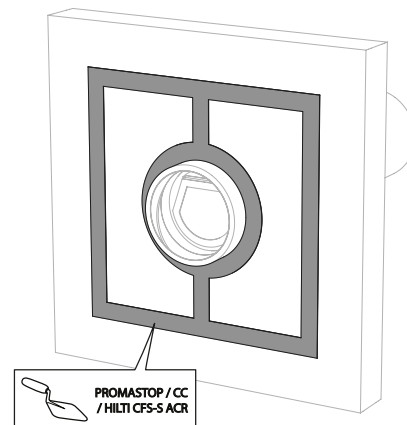

4. The joints on these 2 layers must be installed staggered and covered all around the edge with coating (type PROMASTOP-CC / HILTI CFS-S-ACR).

5

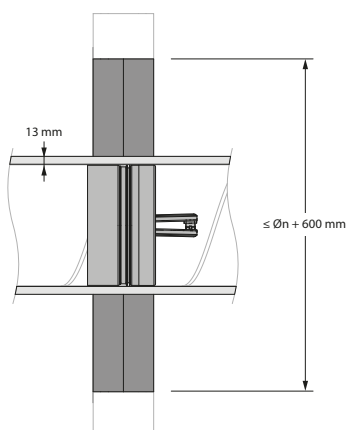

Installation in asymmetric rigid wall with stone wool $\geq 40 \text{ kg/m}^3$ and graphite sealant sealing

The product was tested and approved in:

Range	Wall type	Sealing	Classification
SC60-COSMO \varnothing 100-200 mm	Massive shaftwall	Aerated concrete $\geq 100 \text{ mm}$	El 60 (v_e i \leftrightarrow o) S - (300Pa)

1

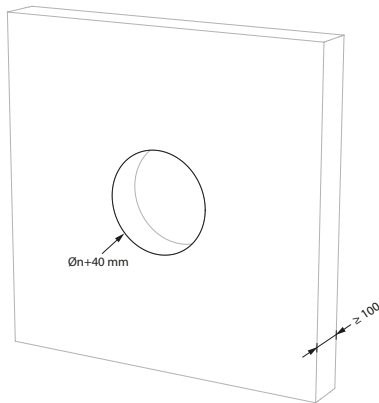

2

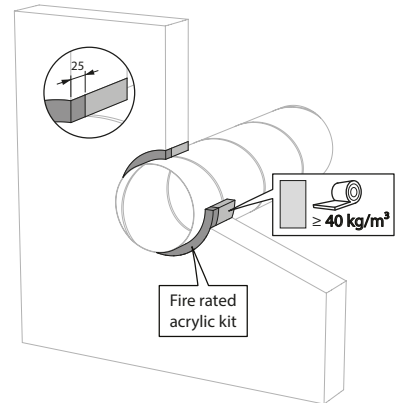

2. The opening around the duct is sealed with soft stone wool and filled with 25mm graphite sealant on the accessible side of the wall.

3

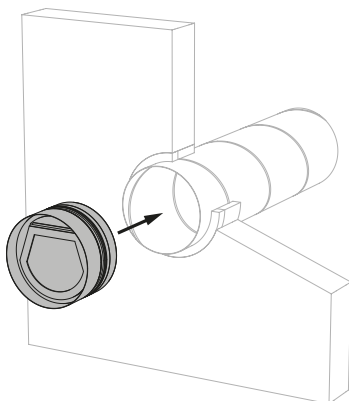

4

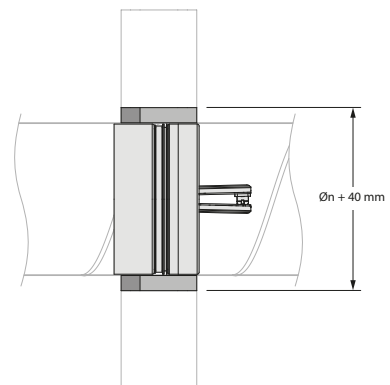

3. Place the SC60-COSMO in the correct direction and orientation.

Installation in asymmetric rigid wall - insulated duct with stone wool $\geq 40 \text{ kg/m}^3$ and graphite sealant sealing

The product was tested and approved in:

Range	Wall type	Sealing	Classification
SC60-COSMO \varnothing 100-200 mm	Massive shaftwall	Insulated duct (ArmaFlex EVO, ArmaFlex Ultima, ArmaFlex Protect – up to 13 mm) + stone wool $\geq 40 \text{ kg/m}^3$ + graphite kit (sealing applied from one side)	EI 60 (v_e i \leftrightarrow o) S - (300Pa)

1

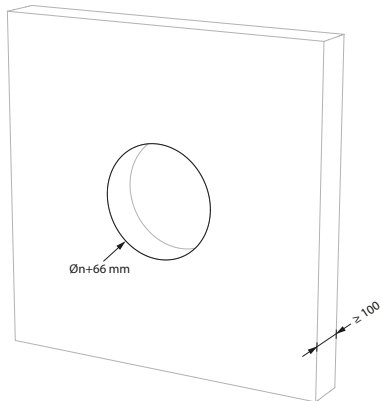

2

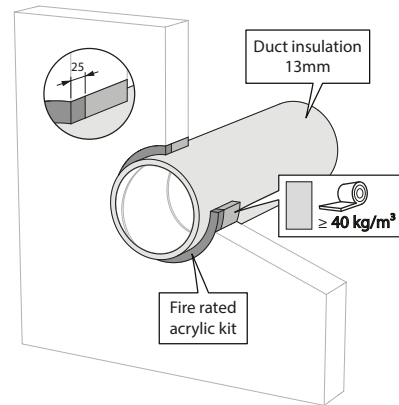

2. The opening around the duct is sealed with soft stone wool and filled with 25mm graphite sealant on the accessible side of the wall.

3

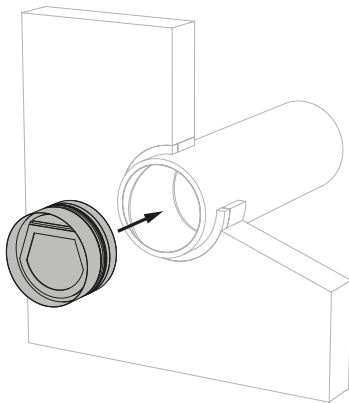

4

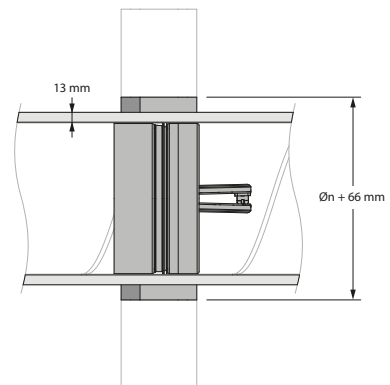

3. Place the SC60-COSMO in the correct direction and orientation.

Installation in flexible wall with stone wool $\geq 40 \text{ kg/m}^3$ and graphite sealant sealing

The product was tested and approved in:

Range	Wall type	Sealing	Classification
SC60-COSMO \varnothing 100-200 mm	Flexible wall	Stone wool $\geq 40 \text{ kg/m}^3$ + graphite kit	El 60 (v_e i \leftrightarrow o) S - (300Pa)

1

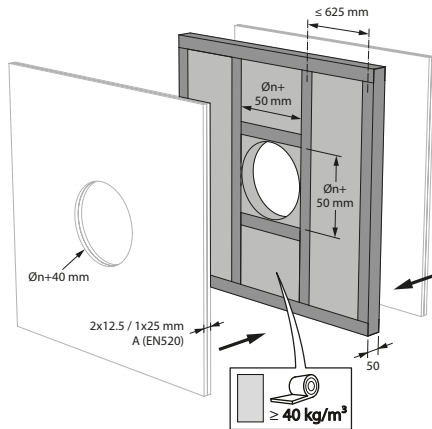

2

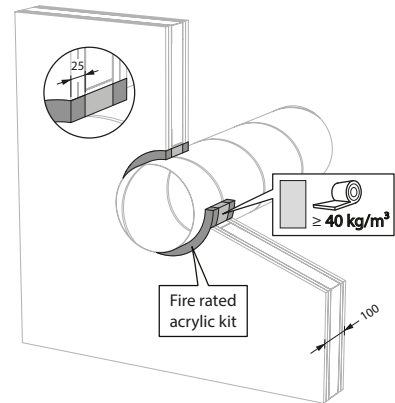

2. The opening around the duct is sealed with soft stone wool and filled with 25mm graphite sealant on both sides of the wall.

3

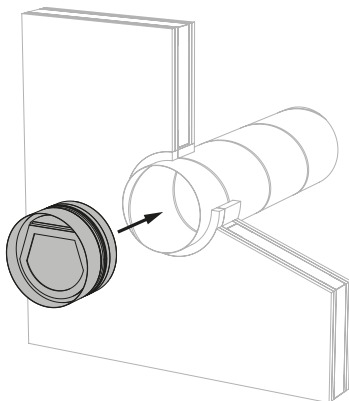

3. Place the SC60-COSMO in the correct direction and orientation.

4

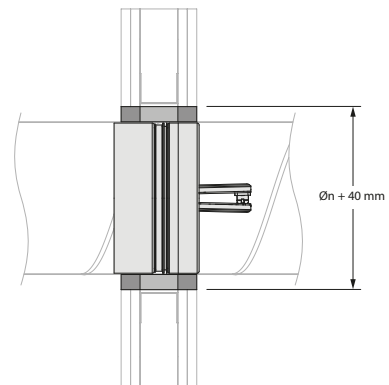

Installation in flexible wall - insulated duct with stone wool $\geq 40 \text{ kg/m}^3$ and graphite sealant sealing

The product was tested and approved in:

Range	Wall type	Sealing	Classification
SC60-COSMO \varnothing 100-200 mm	Flexible wall	Insulated duct (ArmaFlex EVO, ArmaFlex Ultima, ArmaFlex Protect – up to 13 mm) + stone wool $\geq 40 \text{ kg/m}^3$ + graphite kit	EI 60 (v_e i \leftrightarrow o) S - (300Pa)

1

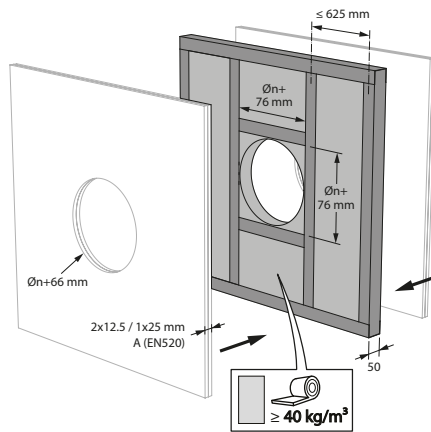

2

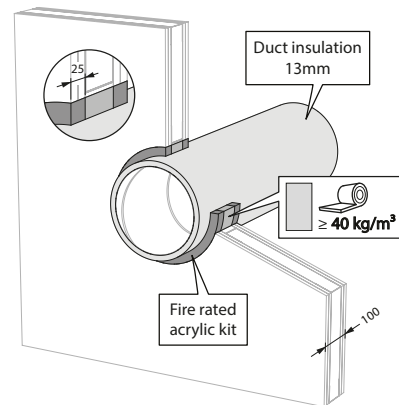

2. The opening around the duct is sealed with soft stone wool and filled with 25mm graphite sealant on both sides of the wall.

3

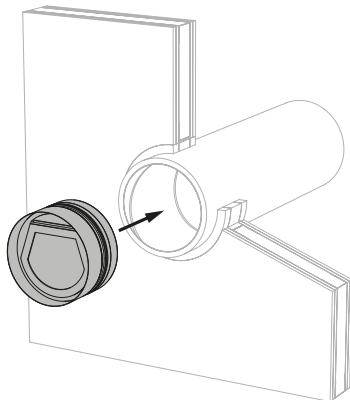

3. Place the SC60-COSMO in the correct direction and orientation.

4

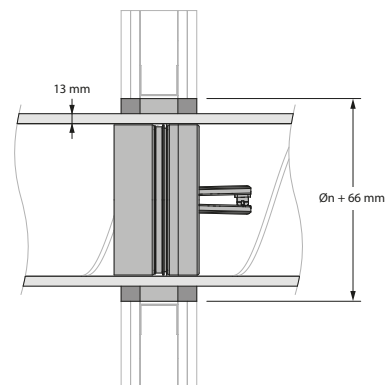

Installation in flexible wall with gypsum sealing

The product was tested and approved in:

Range	Wall type	Sealing	Classification
SC60-COSMO Ø 100-200 mm	Flexible wall	Gypsum	El 60 (v _e i ↔ o) S - (300Pa)

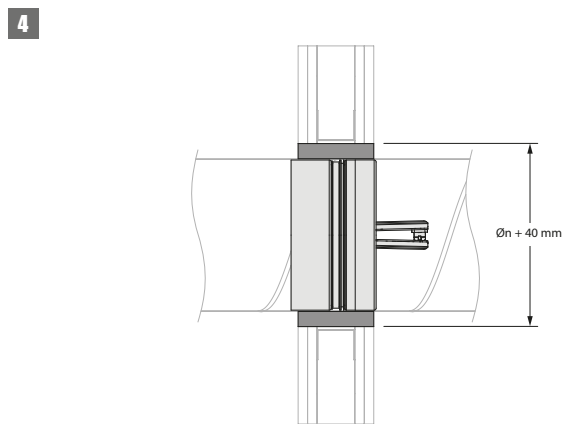
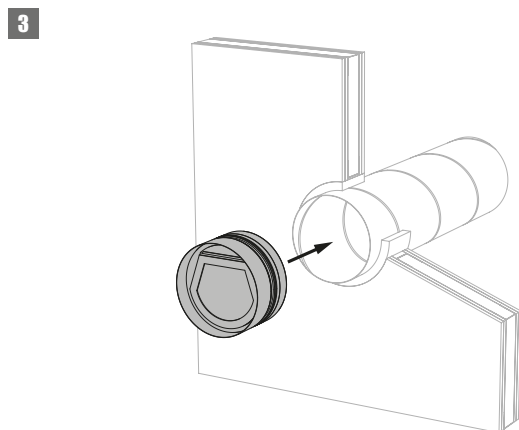
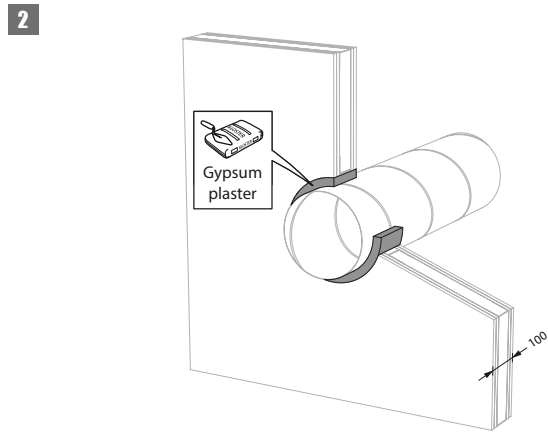
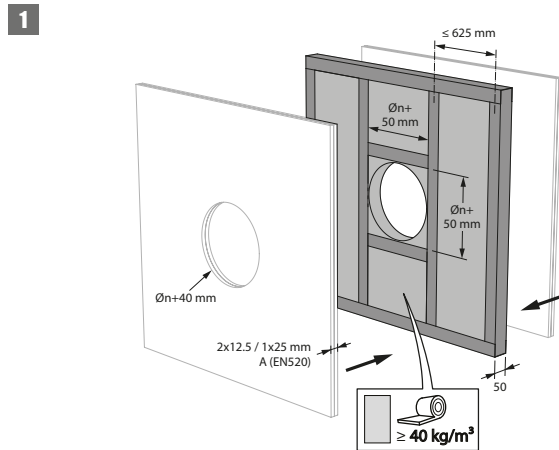

3. Place the SC60-COSMO in the correct direction and orientation.

Installation in flexible wall - insulated duct with gypsum sealing

The product was tested and approved in:

Range	Wall type	Sealing	Classification
SC60-COSMO Ø 100-200 mm	Flexible wall	Insulated duct (ArmaFlex EVO, ArmaFlex Ultima, ArmaFlex Protect – up to 13 mm) + gypsum	El 60 ($v_e i \leftrightarrow o$) S - (300Pa)

1

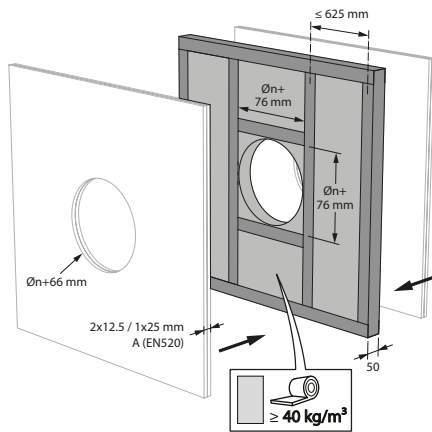

2

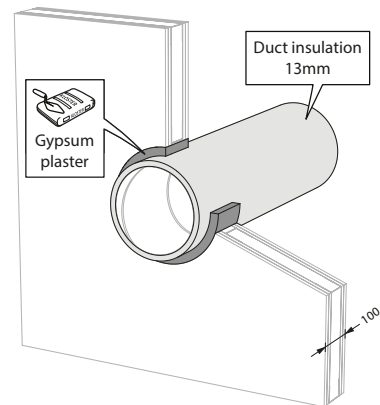

3

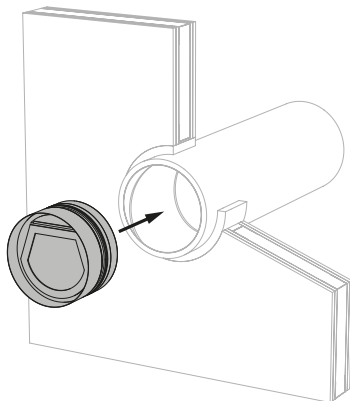

4

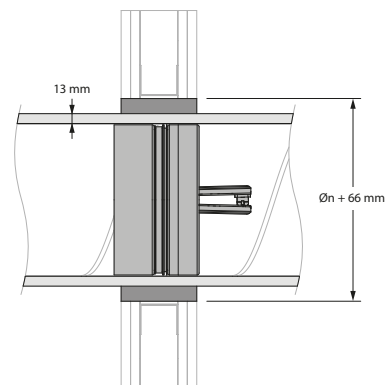

3. Place the SC60-COSMO in the correct direction and orientation.

Installation in flexible wall with fire batt and coating $\geq 140 \text{ kg/m}^3$ sealing

The product was tested and approved in:

Range	Wall type	Sealing	Classification
SC60-COSMO \varnothing 100-200 mm	Flexible wall	Stone wool + coating $\geq 140 \text{ kg/m}^3$	EI 60 (v_e i \leftrightarrow o) S - (300Pa)

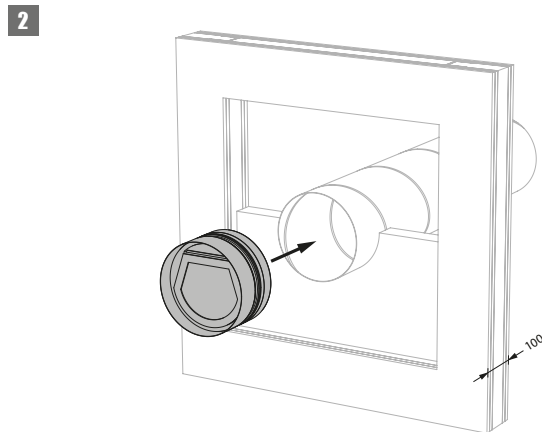
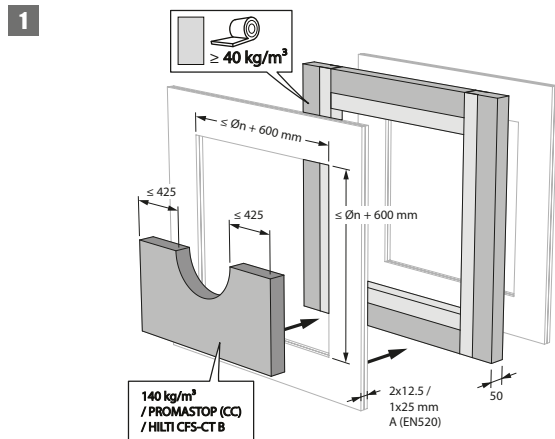

2. Place the SC60-COSMO in the correct direction and orientation.

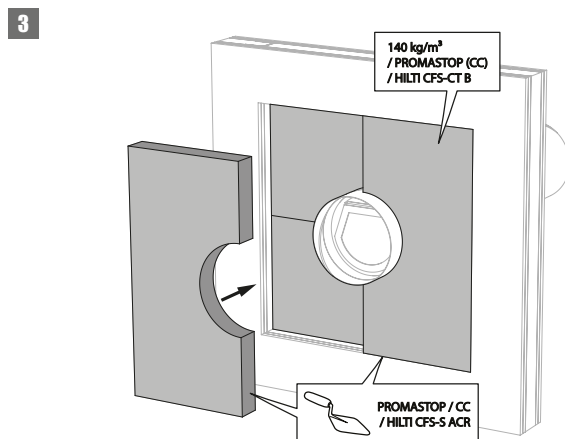

3. The opening in the wall around the duct is sealed with 2 layers of 50 mm-thick stone wool panels with fire resistant coating on one side (type PROMASTOP-CC 50 / HILTI CFS-CT B).

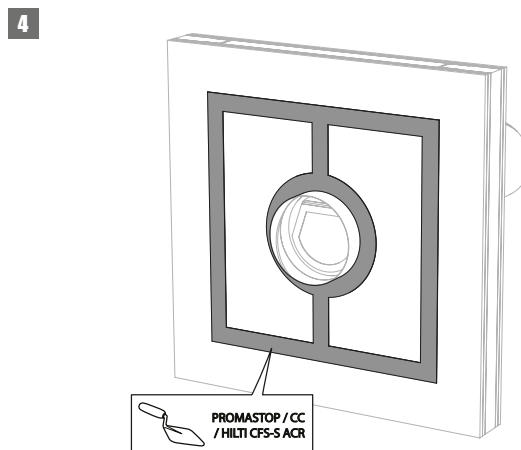

4. The joints on these 2 layers must be installed staggered and covered all around the edge with coating (type PROMASTOP-CC / HILTI CFS-S-ACR).

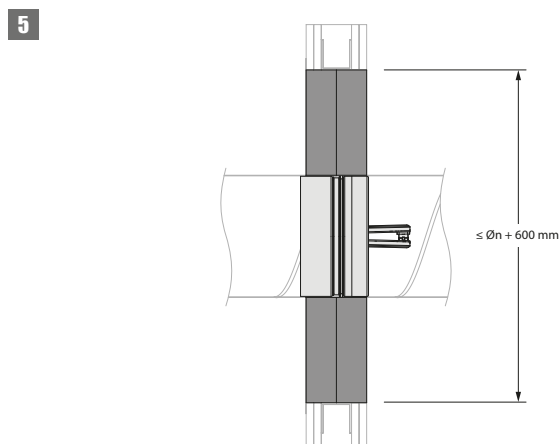

Installation in flexible wall - insulated duct with fire batt and coating $\geq 140 \text{ kg/m}^3$ sealing

The product was tested and approved in:

Range	Wall type	Sealing	Classification
SC60-COSMO \varnothing 100-200 mm	Flexible wall	Insulated duct (ArmaFlex EVO, ArmaFlex Ultima, ArmaFlex Protect – up to 13 mm) + stone wool + coating $\geq 140 \text{ kg/m}^3$	El 60 (v_e i \leftrightarrow o) S - (300Pa)

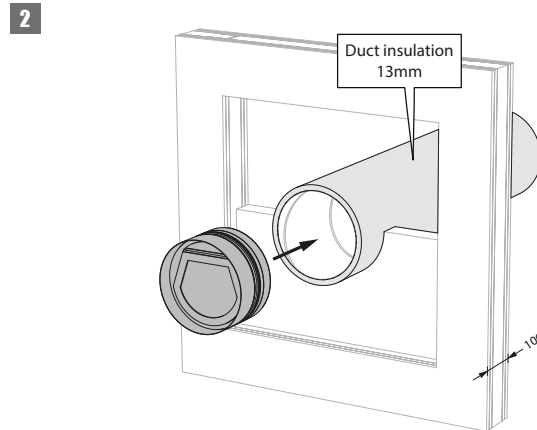
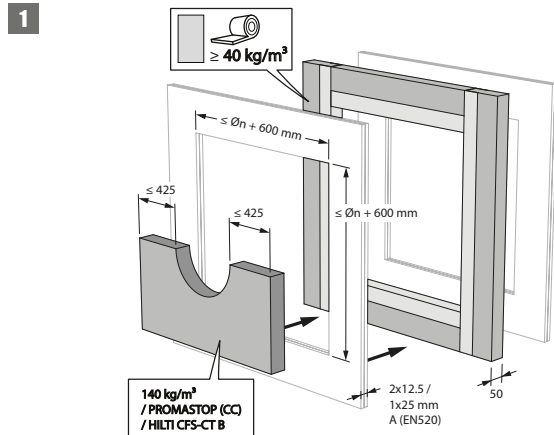

2. Place the SC60-COSMO in the correct direction and orientation.

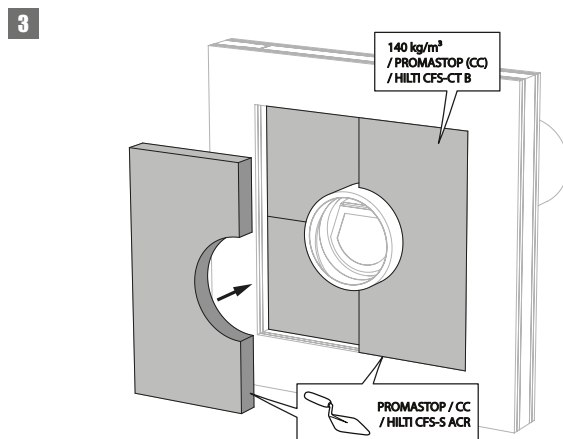

3. The opening in the wall around the duct is sealed with 2 layers of 50 mm-thick stone wool panels with fire resistant coating on one side (type PROMASTOP-CC 50 / HILTI CFS-CT B).

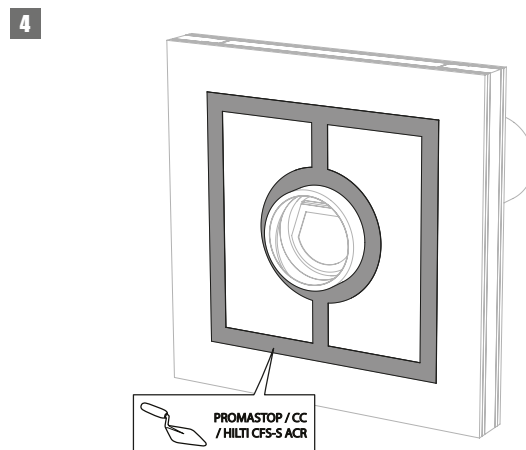

4. The joints on these 2 layers must be installed staggered and covered all around the edge with coating (type PROMASTOP-CC / HILTI CFS-S-ACR).

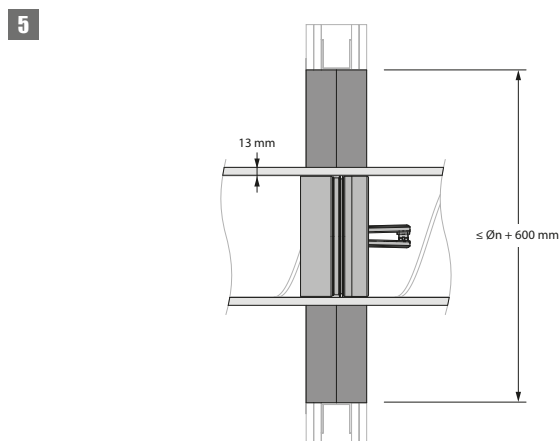

Installation in asymmetric flexible wall with fire batt and coating $\geq 140 \text{ kg/m}^3$

The product was tested and approved in:

Range	Wall type	Sealing	Classification
SC60-COSMO \varnothing 100-200 mm	Asymmetric flexible wall	Stone wool $\geq 140 \text{ kg/m}^3$ + coating (sealing applied from one side)	EI 60 (v_e i \leftrightarrow o) S - (300Pa)

1

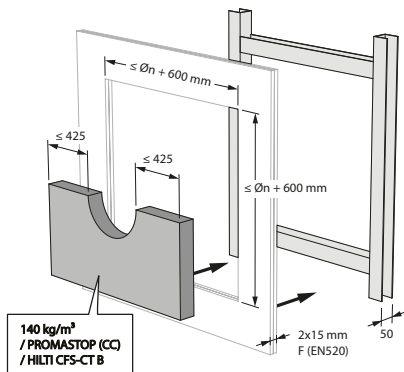

2

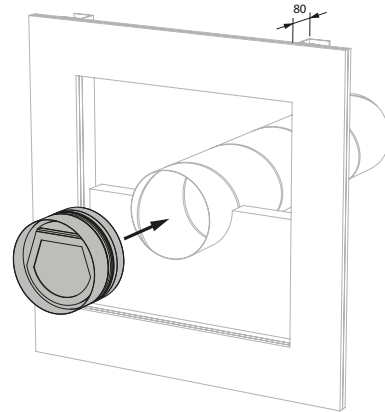

2. Place the SC60-COSMO in the correct direction and orientation.

3

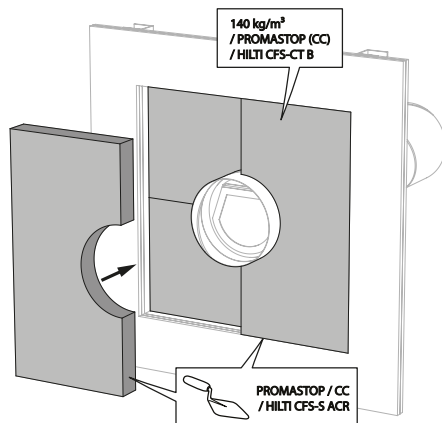

3. The opening in the wall around the duct is sealed with 2 layers of 50 mm-thick stone wool panels with fire resistant coating on one side (type PROMASTOP-CC 50 / HILTI CFS-CT B).

4

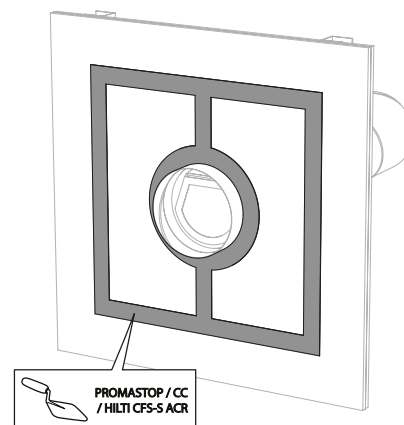

4. These boards must be installed staggered and, on the accessible side, the joints must be covered all around with filling paste (type PROMASTOP-CC / HILTI CFS-S-ACR).

5

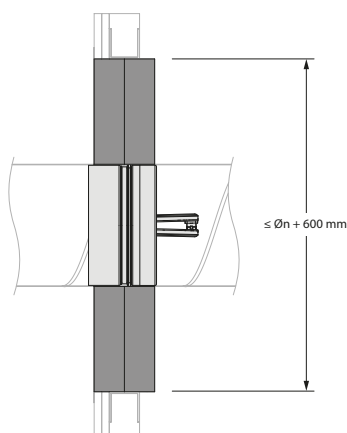

Installation in asymmetric flexible wall - insulated duct with fire batt and coating $\geq 140 \text{ kg/m}^3$

The product was tested and approved in:

Range	Wall type	Sealing	Classification
SC60-COSMO \varnothing 100-200 mm	Asymmetric flexible wall	Insulated duct (ArmaFlex EVO, ArmaFlex Ultima, ArmaFlex Protect – up to 13 mm) + stone wool $\geq 140 \text{ kg/m}^3$ + coating (sealing applied from one side)	El 60 (v_e i \leftrightarrow o) S - (300Pa)

1

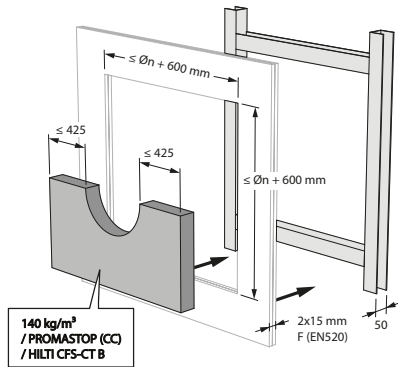

2

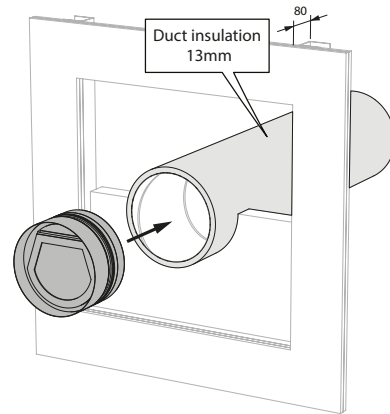

2. Place the SC60-COSMO in the correct direction and orientation.

3

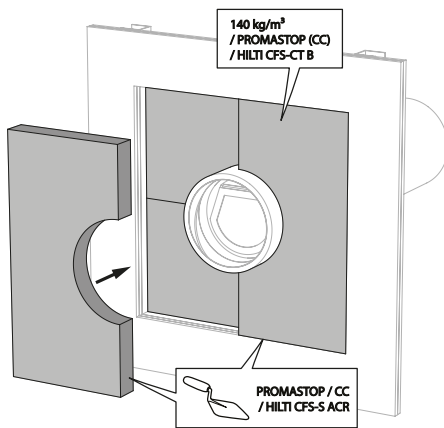

3. The opening in the wall around the duct is sealed with 2 layers of 50 mm-thick stone wool panels with fire resistant coating on one side (type PROMASTOP-CC 50 / HILTI CFS-CT B).

4

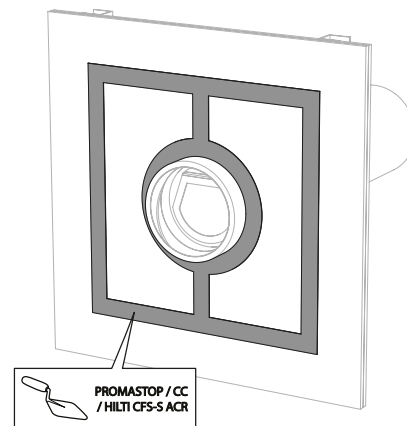

4. These boards must be installed staggered and, on the accessible side, the joints must be covered all around with filling paste (type PROMASTOP-CC / HILTI CFS-S-ACR).

5

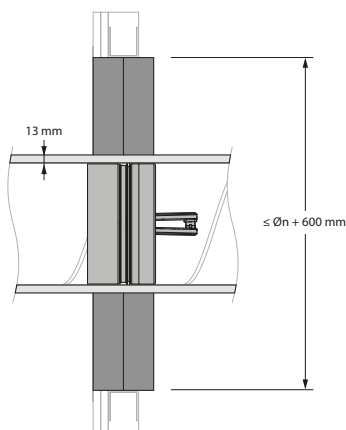

Maintenance

- No specific maintenance required.
- Schedule at least 2 visual checks each year.
- Remove dust and all other particles before use.
- Follow local maintenance regulations (i.e. BS9999 Annex V; NF S 61-933) and EN13306.
 - ⚠ Warning: butterfly dampers, in their closed position, can move in the duct when placed under too high pressure.

Weights

SC60-COSMO

ØDn [mm]	100	125	160	200
kg	0,4	0,5	0,7	0,9

Selection data

$$\Delta p \text{ [Pa]} = a \cdot v^2 + b \cdot v + c$$

ØDn [mm]	100	125	160	200
a	1,87	1,95	1,53	0,54
b	10,42	5,51	3,22	4,78
c	10,11	10,12	10,10	9,96

Sample order

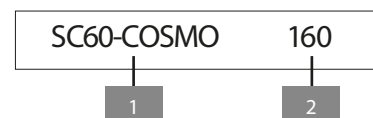

- 8. product
- 9. diameter

Approvals and certificates

All our products are submitted to a number of tests by official test institutes. Reports of these tests form the basis for the approvals of our dampers.

CE
0749

BCCA-0749-CPR-BC1-606-0464-15650.09-2517